

Lug Lock

The Richards innovative CS8 and R800 products will be available with the new LugLock feature to make installation even easier and more reliable. Missed lug installation has been a long-standing challenge in medium voltage elbow applications. This condition is not visually obvious during installation and can lead to serious reliability and safety concerns.

Inspired by Lockout/Tagout (LOTO) safety procedures, LugLock is a “lock out” mechanism built into the elbow to ensure the lug is correctly positioned prior to installation onto the equipment bushing or mating part. The feature is designed to provide the installer with direct feedback that the lug is not in the correct position during the installation process. This functionality “locks out” the elbow to prevent installation until the lug is returned to the correct location. By eliminating the possibility of a missed lug, LugLock significantly improves installation reliability and confidence in the field.

✗ Partially Seated - Locked

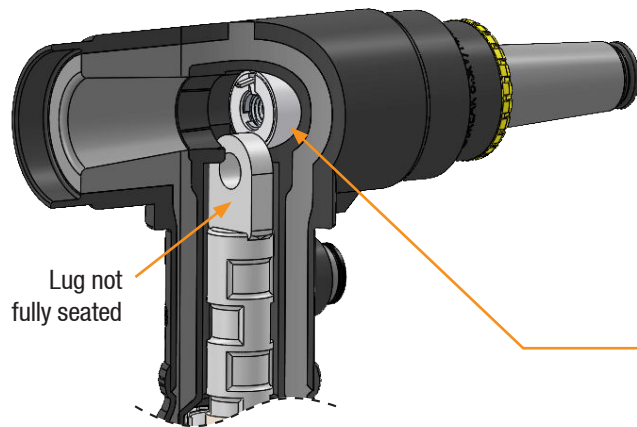

LugLock Fastener locked

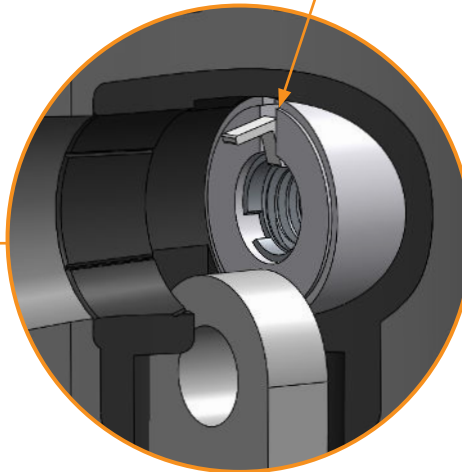

✓ Fully Seated - Unlocked

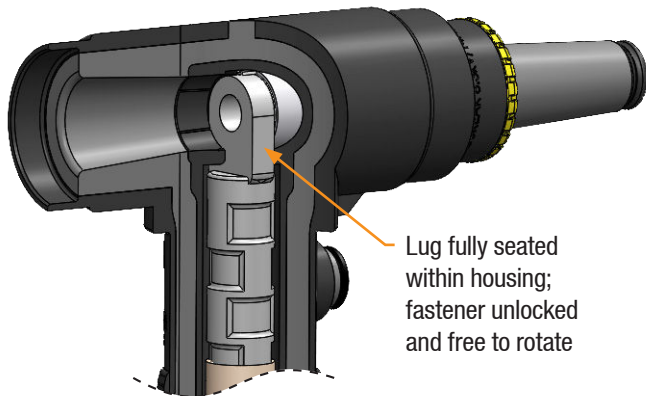

Features & Benefits

INTEGRATED LUG LOCK-OUT MECHANISM: Prevents installation unless the lug is correctly positioned within the elbow, eliminating missed-lug conditions before they occur.

DIRECT INSTALLER FEEDBACK: Tactile feedback for installer to confirm the lug is in the correct position. If hex tool rotates freely, the lug is in the correct position. If hex tool does not rotate freely, the fastener is still locked.

RE-ENGAGEMENT PROTECTION: If the lug drops after initial positioning, the lock re-engages every 120° (1/3 turn).

REDUCED INSTALLATION ERRORS: Removes ambiguity with false “tight fit” indications.

COMPREHENSIVE STRENGTH TESTS: LugLock mechanism components have gone through a series of force tests to confirm strength and reliability.

Applicable Series



R-800



CS8