

# Installation Instructions

## TSCS Series Cold Shrink Sleeve for Insulated Network Protector Terminal

### Applicable Catalog Codes

#### Limiter Lugs

312-1409-00

#### Standard Lugs

312-1409-01

### For Use With the Following Terminals

#### w/o OFB

312-1407-10

#### w/ OFB

312-1408-10

## KIT CONTENTS

Check package contents to be sure they are complete, undamaged, and properly sized for the application.



**Cold Shrink Sleeve**  
(for Limiter Lugs)

OR

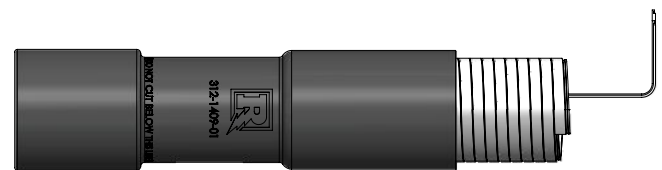

**Cold Shrink Sleeve**  
(for Standard Lugs)



**Jacket Mastic**  
(1) Piece



**Grease**

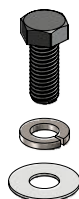

**Hardware**  
(pre-installed on terminal)  
 1/2"-13 Hex Head Bolt, 1.25" LG, 316 Stainless Steel  
 1/2" Split Lock Washer, 316 Stainless Steel  
 1/2" Flat Washer, 316 Stainless Steel  
 (2 Sets per leg)



**Terminal Cap**  
(pre-installed on terminal)  
 312-1407-01



Scan QR code to  
watch Limiter Lug  
installation video



Scan QR code to  
watch Standard Lug  
installation video

# 1

- A. Remove pre-installed Terminal Cap from Terminal Leg by rocking back and forth. Remove pre-installed hardware from Terminal Spade.
- B. Slide Cold Shrink Sleeve over cable to store it. Orient pull tab of ribbon core so that it is facing away from lug end. Sleeve must be parked before lug is installed.
- C. Align lug with Terminal Spade and bolt in place using supplied Hardware. Install bolt along with ALL included washers in the correct order as shown in kit contents section.



# 2

- A. Apply one piece of jacket mastic at position shown by wrapping fully around outer jacket.
- B. Apply electrical tape completely covering mastic to prevent movement when ribbon core is removed.
- C. Using supplied or approved silicone grease, lubricate Terminal Leg.



# 3

- A. Install Cold Shrink Sleeve onto Terminal Leg.
- B. Unwind pull tab of ribbon core to shrink Sleeve. Ensure mastic is completely covered by deployed Sleeve.



# 4

- A. Repeat steps above for other cable connections.
- B. Ensure all unused Terminal Legs are covered with Terminal Caps.



## Installation Complete

