

Swivel Nuts

Product Data Sheet

The Richards Swivel Nut is a unique hardware solution that combines a nut, lock washer and flat washer into a convenient, captive design. Offered in a variety of types to meet various applications--from underground to overhead systems--the Swivel Nut facilitates hardware installation for lineman and network mechanics. These workers wear bulky protective gloves and work in environments where dropping loose hardware is undesirable and sometimes dangerous. We created this captive design to make the threading/bolting operation as easy as possible.

We currently offer a variety of nut sizes and finishes for various applications. For example, we have a Swivel Nut with a galvanized finish for use with pole line hardware.

If you do not see the finish, size, or application you are interested in, please contact your local sales representative or the factory to discuss development of a configuration that meets your requirements.

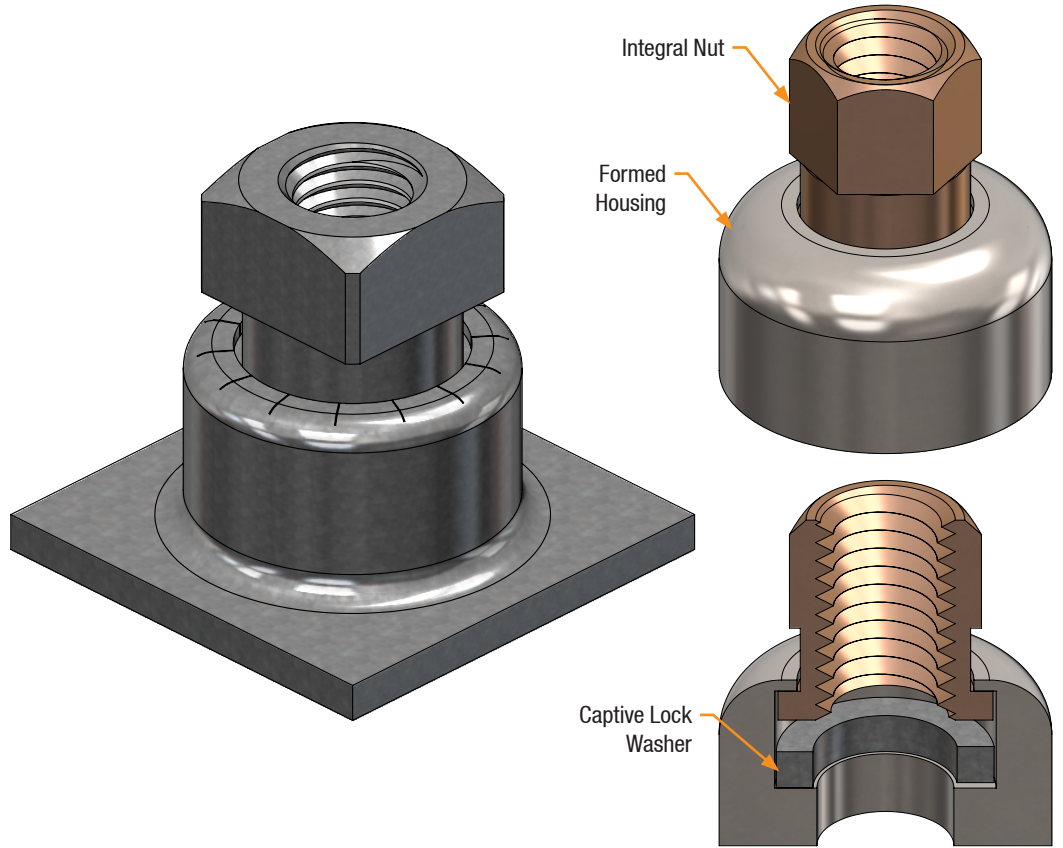

Features

- Integral Nut
- Captive Lock Washer
- Formed Housing Acts as Flat Washer

Product Details

Part Number	Thread Size	Nut Size	Material Details	Common Application(s)
SN-1/4-REL	1/4"-20	Thumb Screw	Zinc Plated Steel	Network Protector Relay
SN-1/2-SBR	1/2"-13	3/4" Hex	Silicon Bronze Nut, Stainless Steel Housing	Outdoor Electrical Equipment
SN-1/2-ZP	1/2"-13	3/4" Hex	Zinc Plated Steel	Indoor, Bus and Fuses
SN-3/8-GAL	3/8"-16	9/16" Hex	Galvanized Steel	Pole Line Hardware
SN-5/8-GAL	5/8"-11	1" Square	Galvanized Steel	Machine Bolts - Overhead Hardware
SN-3/4-GAL	3/4"-10	1-1/8" Square	Galvanized Steel	Machine Bolts - Overhead Hardware