

15/25/28kV Grounding Bushing

Product Data Sheet

The Richards P625GB is a 15/25/28kV 600A Deadbreak interface connected to a 4/0 AWG copper grounding cable. The grounding cable comes pre-stripped and tinned at the end to facilitate any connection to ground. Custom end connections available on request. The Grounding Bushing has a stainless steel mounting bracket and hot-stick-operable mounting hardware for insertion into a parking stand. The Grounding Bushing can be connected to a Richards Deadbreak Elbow to ground the circuit.



Features

- 6 ft. 4/0 AWG copper welding cable
- Yellow cable insulation provides clear indication that bushing is for grounding purposes
- Provided with hotstick eye

Basic Dimensions

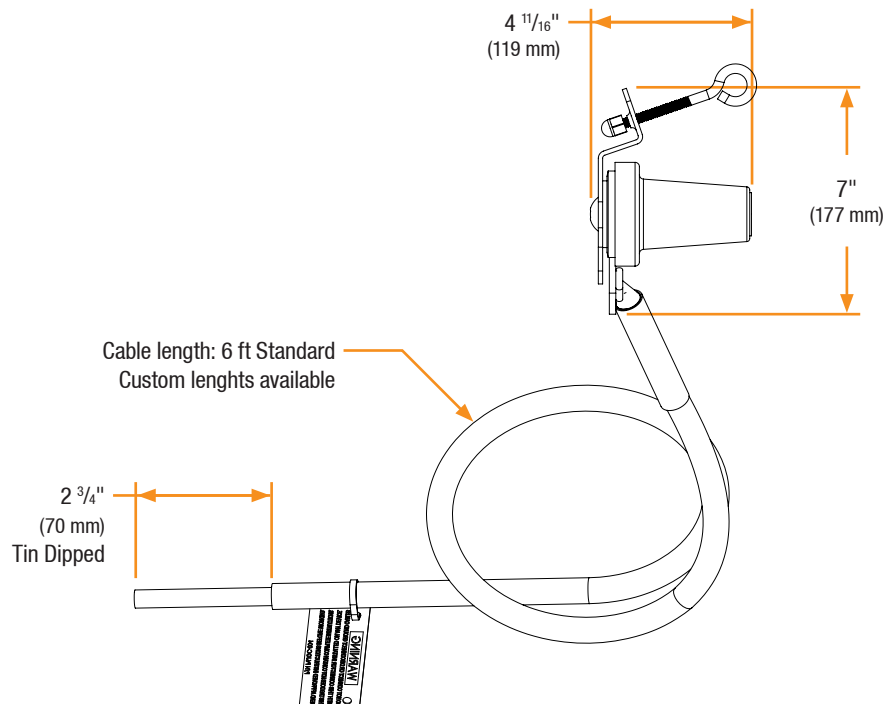

15/25/28kV Grounding Bushing

Installation

15/25/28kV Grounding Bushing installation is covered by:
RP-II-GB

Related Products

P625HIP-STUD

15/25/28kV Aluminum Threaded Stud

P925HIP-STUD

15/25/28kV Copper Threaded Stud

62LCN/62LCT

15/25/28kV Deabreak Elbow

92LCN/92LCT

15/25/28kV Deabreak Elbow

P625IC

15/25/28kV Aluminum Insulating Cap

P925IC

15/25/28kV Copper Insulating Cap

Detail View

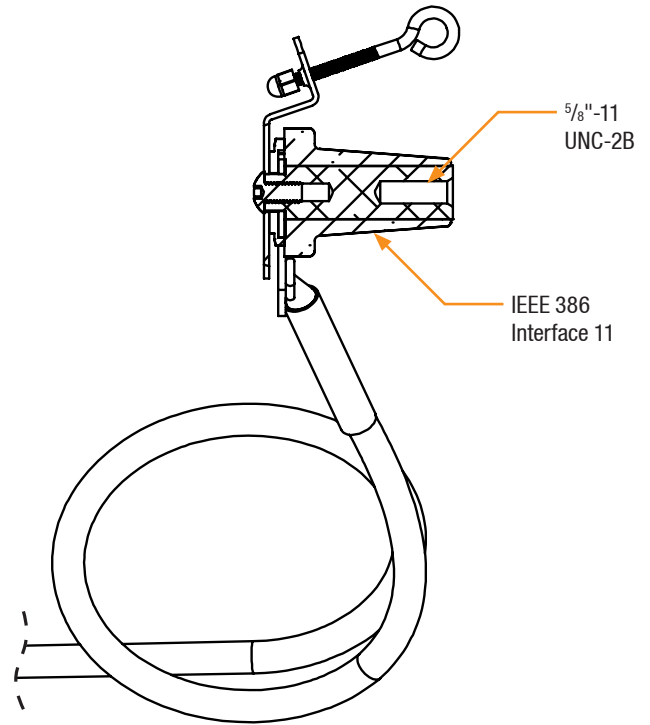

Production Testing

IEEE requires a Partial Discharge test and choice between AC withstand and Impulse.

Richards runs 3/3 tests on **all** Medium Voltage products governed by IEEE 386. [®]

100% Routine Electrical Test:

- Partial Discharge
- AC Withstand
- Impulse Withstand

Product Ratings

Current Ratings

Momentary	25kA, 10c. and 10kA, 3s.
-----------	--------------------------

The 15/25/28kV Grounding Bushing is qualified to the following industry standards:

- IEEE Std 386: For Separable Insulated Connector Systems

[®] Exceeds IEEE 386 requirement