

# 15/25kV Apparatus Bushings

Product Data Sheet

Richards 15/25 kV 600A (P625AB) and 900A (P925AB) Deadbreak Apparatus Bushings are Medium Voltage accessories utilized in equipment such as Transformers to provide a mating interface for 15/25kV Deadbreak components.

The Bushings are Epoxy-Molded and feature Stainless Steel flanges for welding to the equipment case. They are available in multiple shank lengths as shown in the below table.

Apparatus bushings can be ordered with a factory-installed threaded stud. Add "-S" to the part number for a factory-installed threaded stud.



## Features

- Made in the USA
- Injection-Molded Epoxy
- Integral Shank Threaded Stud
- Available w/ 200kV BIL Rating

## Bushings Sizing

Part Number	Shank Length "A"	Contact Length "B"	Overall Length "C"
P625AB-3 P925AB-3	2-7/8"	6-7/8"	8-1/8"
P625AB-9 P925AB-9	8-1/2"	12-1/2"	13-3/4"
P625AB-12 P925AB-12	12"	16"	17-1/4"

## Basic Dimensions

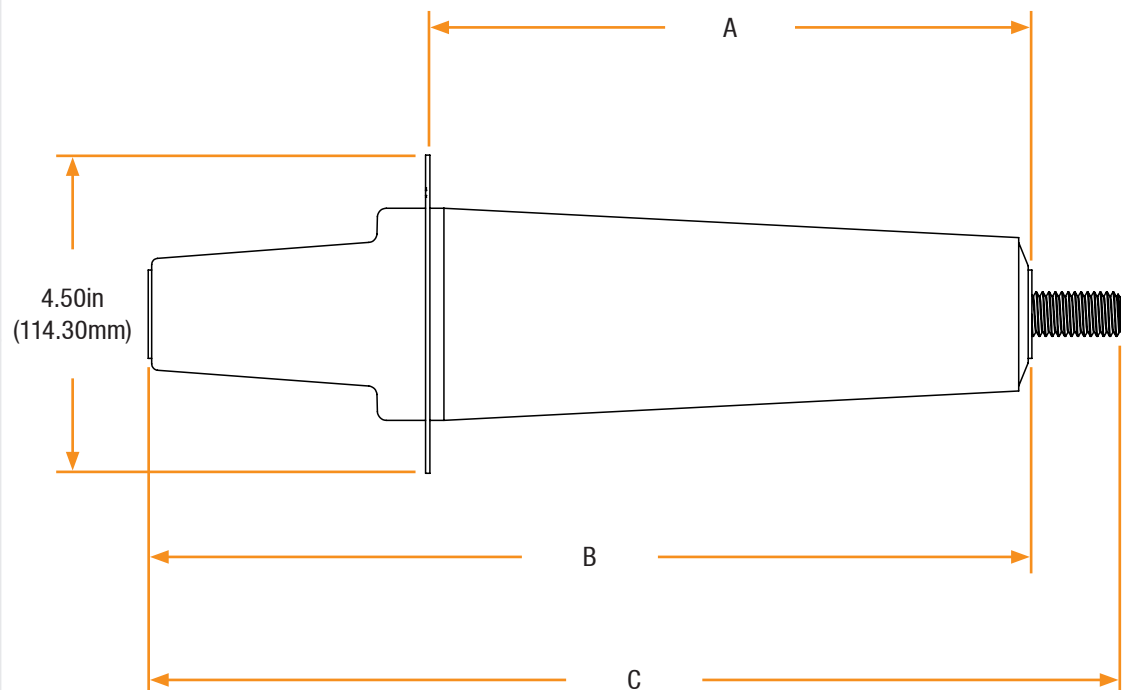

# 15/25kV Apparatus Bushings

## Installation

15/25kV Apparatus Bushing installation is covered by:  
**RP-II-P635AB**

## Related Products

### P625HIP-STUD

15/25kV Aluminum Threaded Stud

### P925HIP-STUD

15/25kV Copper Threaded Stud

### 62LCN/62LCT

15/25kV Deadbreak Elbow

### 92LCN/92LCT

15/25kV Deadbreak Elbow

### P625HIP

15/25kV Aluminum Insulating Plug

### P925HIP

15/25kV Copper Insulating Plug

## Detail View

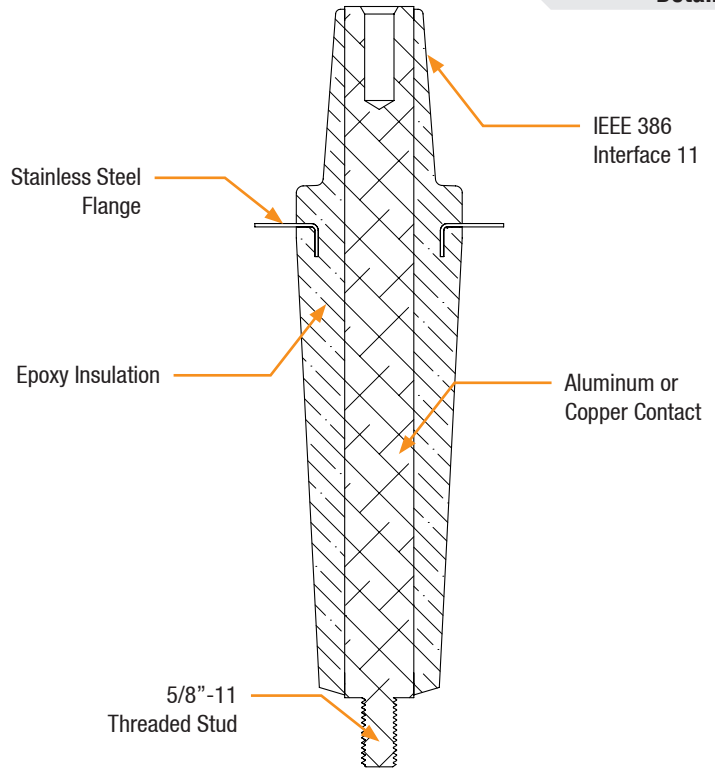

## Production Testing

IEEE requires a Partial Discharge test and choice between AC withstand and Impulse.

Richards runs 3/3 tests on **all** Medium Voltage products governed by IEEE 386. <sup>®</sup>

### 100% Routine Electrical Test:

- Partial Discharge
- AC Withstand
- Impulse Withstand

Richards Apparatus Bushings are designed to allow for production testing at 200kV BIL. For more information see our 200kV BIL Product Data Sheets or contact the factory.

## Product Ratings

### Voltage Ratings

Maximum Voltage Rating – (phase to ground)	15.2kV
Corona Voltage Level – (partial discharge extinction voltage)	22kV <sup>®</sup>
AC Withstand – (1 minute)	42kV <sup>®</sup>
Impulse-Withstand Voltage – (BIL)	162kV BIL <sup>®</sup>

### Continuous Current Ratings

Aluminum	600A
Copper	900A

### Short-Time Current Ratings

Aluminum	40kA, 10c. and 10kA, 3s. <sup>®</sup>
Copper	40kA, 10c. and 10kA, 3s.

The 15/25kV Apparatus Bushings are qualified to the following industry standards:

- IEEE Std 386: For Separable Insulated Connector Systems
- ANSI C119.4: For Electric Connectors
- IEEE Std 592: For Exposed Semiconducting Shields

<sup>®</sup> Exceeds IEEE 386 requirement